

# GRASSY BRANCH *at Bridgewater*

**NOW ACCEPTING DEPOSITS FOR LOT RESERVATIONS**  
**START BUILDING YOUR DREAM HOME — SPRING 2019**

- 60 generously sized lots, most have the option for daylight basement windows, some walk-out basement lots
- Beautiful lots include views of our four lakes and expansive wooded common areas, complimented by street trees located throughout the neighborhood, as well as extensive landscaping along Carey Road and 151st Street
- Three gated entries, one at Carey Road and two accessing the Maple Ridge neighborhood to the west allowing connectivity to Oak Road
- Community trail through the neighborhood along the creek common area connecting the miles of Bridgewater community trails to the Maple Ridge community trails
- Development open to qualified and approved custom builders
- All lots include Social Membership to The Bridgewater Club

**WE LOOK FORWARD TO HEARING FROM YOU,**  
**YOUR BUILDER OR REAL ESTATE PROFESSIONAL**

For more information please contact David Mennel at 317-399-2490  
or [david.mennel@thebridgewaterclub.com](mailto:david.mennel@thebridgewaterclub.com)



3535 East 161st Street Carmel, IN 46033 [www.thebridgewaterclub.com](http://www.thebridgewaterclub.com)

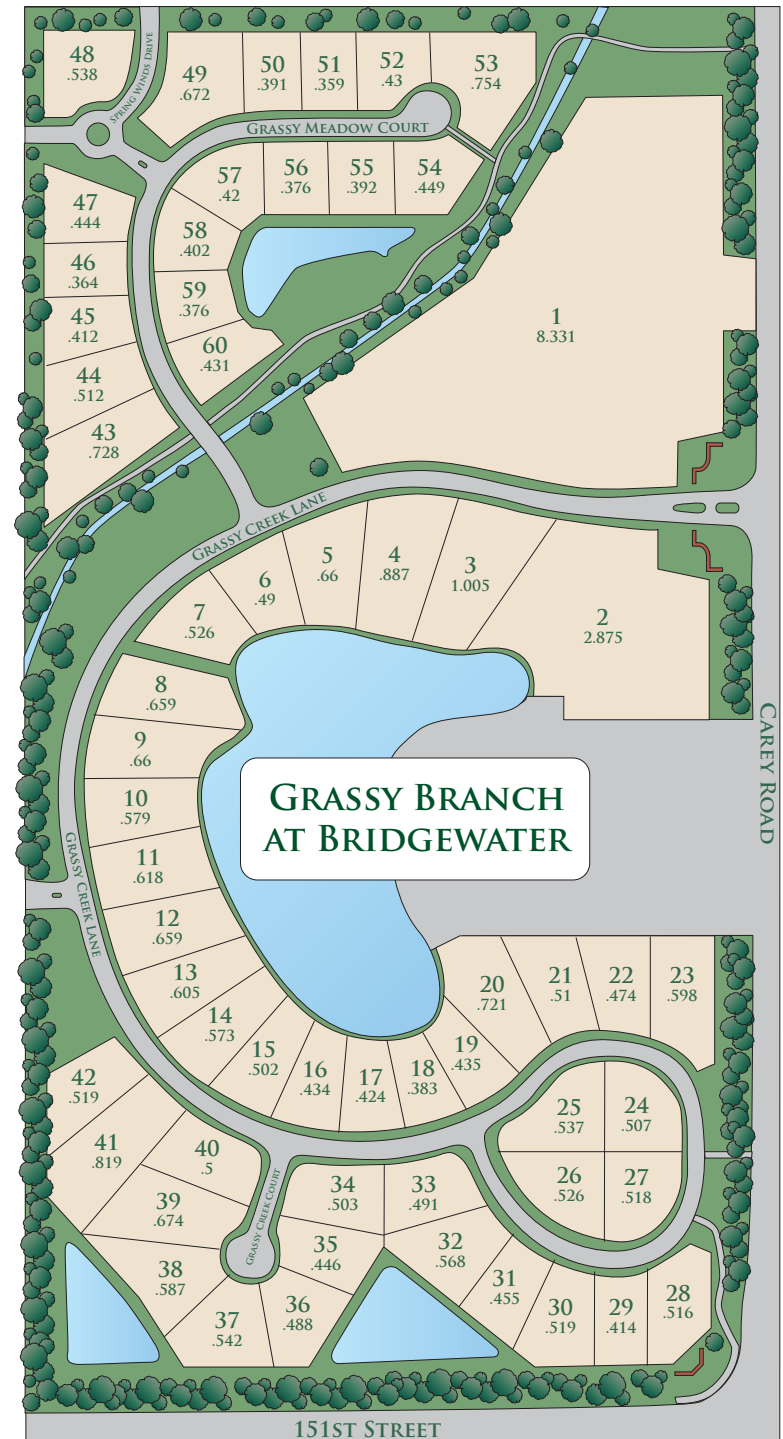

Lot sizes represented as acreage percentage.